



FACADE STEEL FIXING SYSTEM



Adjustable Natural Stone Fixing Components

**ADJUSTABLE NATURAL STONE FIXING COMPONENTS**

**Z ANCHOR COMPONENTS**

PLDTM.30030

PLDTM.20010

PLDTM.20100

PLDTM.60010

PLDTM.30110

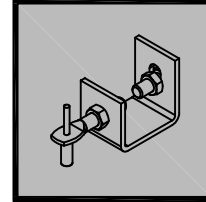
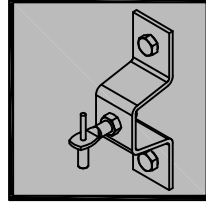
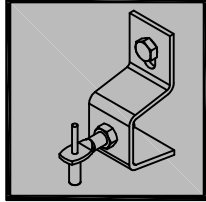
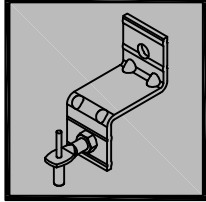
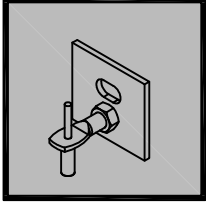

**L ANCHOR COMPONENTS**

PLDTM.70010

PLDTM.70020

PLDTM.70040

PLDTM.70050

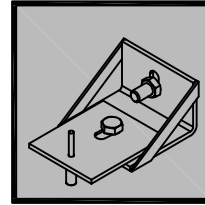
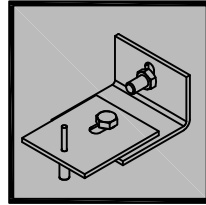
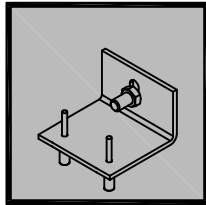
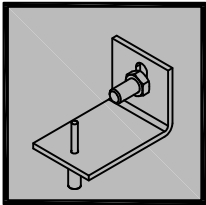

**PROFILES**

PLUYYD.4030

PLCYD.4121

PLGSD.4121

PLGSD.4141

PLLYD.4040

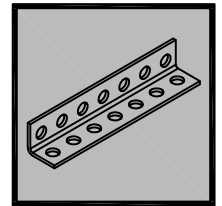
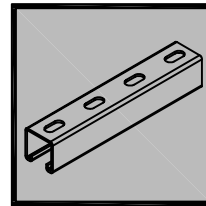
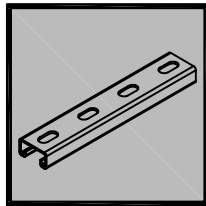
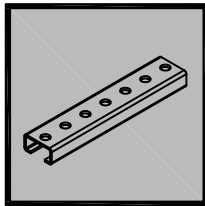
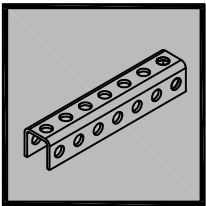

**TYPICAL ADJUSTABLE SYSTEM DETAILS**

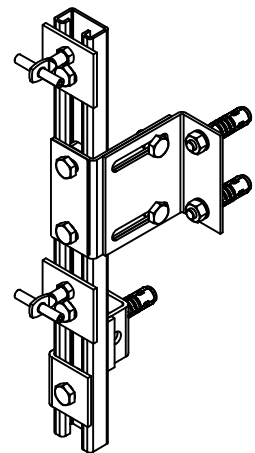
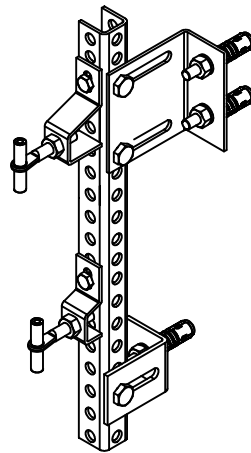
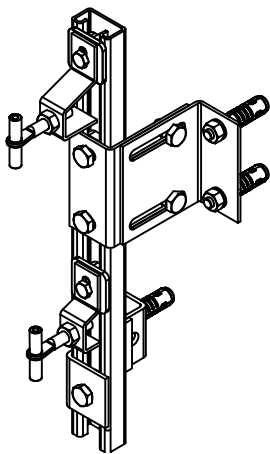

PROLINK G and C Cross Section Profiles

PROLINK G and C Cross Section Profiles

Profile Type	
Profile Section	Size Thickness
C Profil	35x21 0,9
C Profil	35x35 0,9
C Profil	35x35 1,2
G Profil	41x21 2,0
G Profil	41x41 2,0
G Profil	45x22 2,5
G Profil	45x45 2,5
G Profil	45x60 2,5
G Profil	60x70 3
G Profil	60x85 3

C Profil

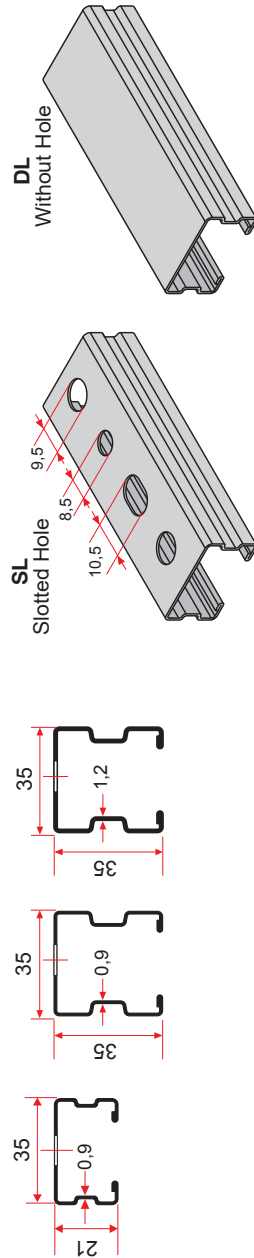

G Profil

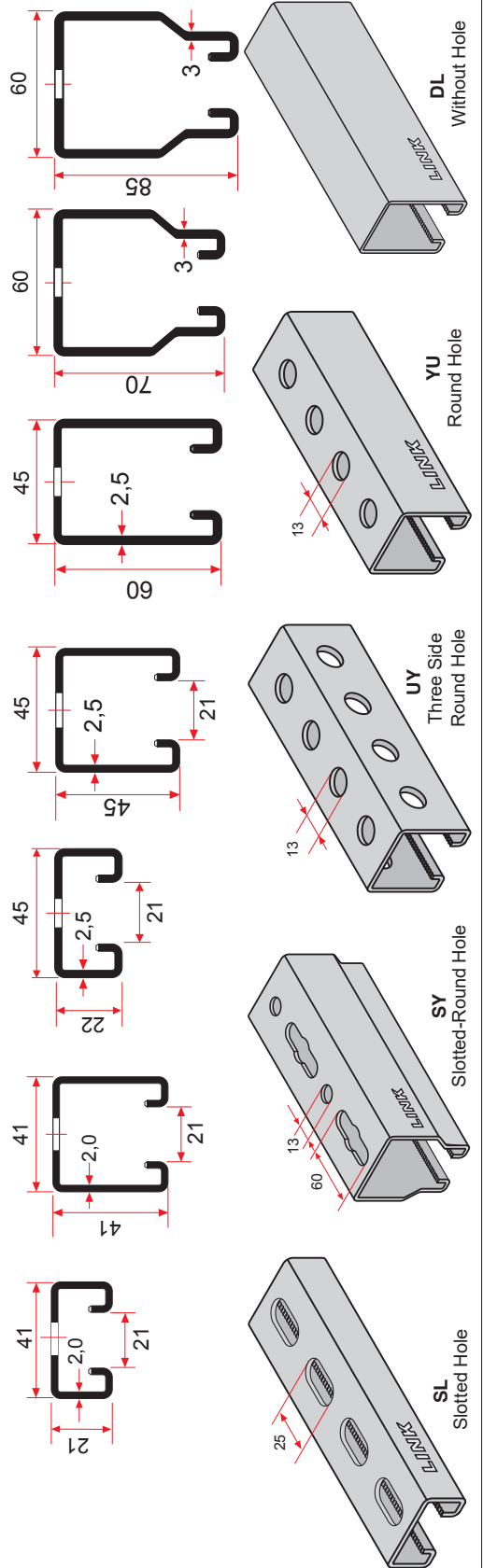

Surface Anchor  
Technical Details

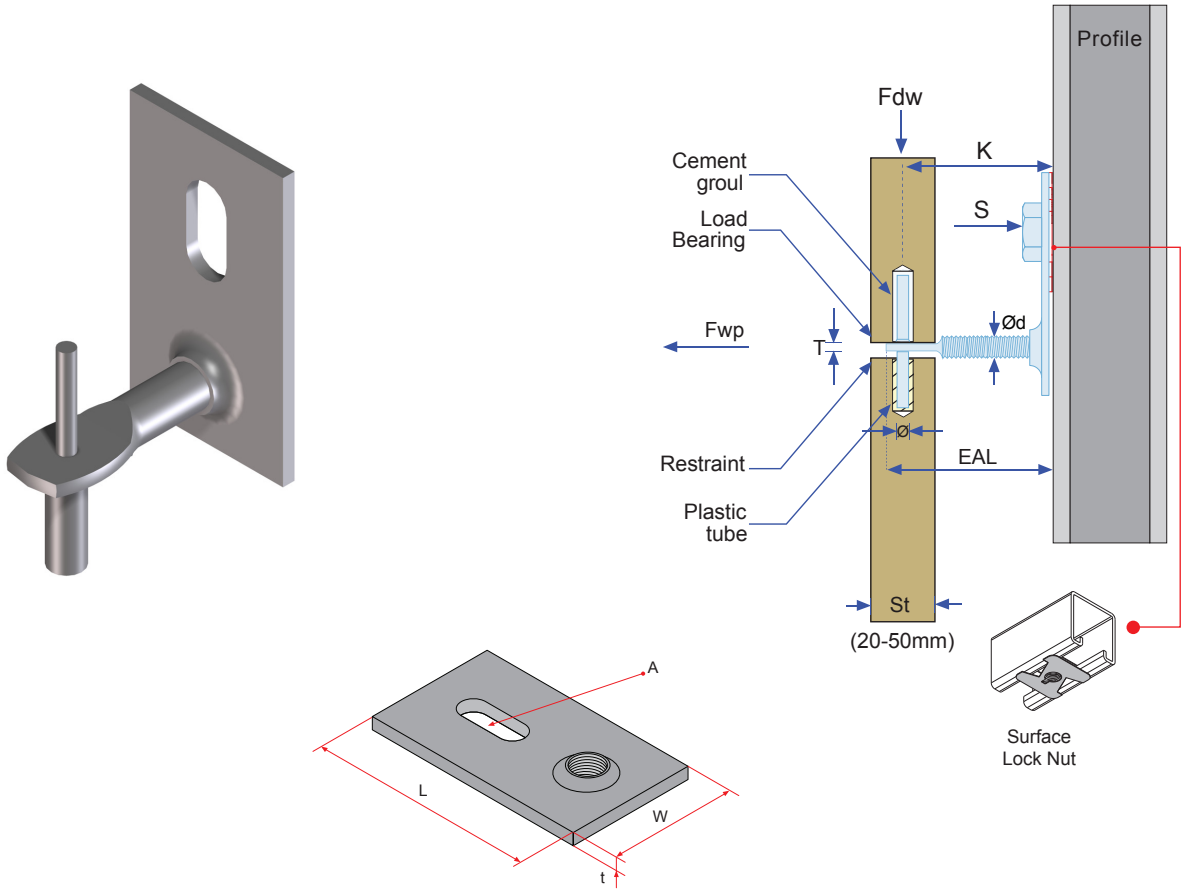

Product Code	Ød	A	L	W	t	Fdw Min. Projection	Fdw Max. Projection	Dead Load					Fwp Max. Wind Load
								K (Acc. to Projection Distance)					
								30 mm	40 mm	60 mm	80 mm	100 mm	
N	N	N	N	N	N	N							
DTM.30010	M.8	9x15	60	35	2	30	50	250	170	-	-	-	500
DTM.30020	M.10	11x22	70	40	3	40	80	-	370	312	250	-	750
DTM.30030	M.10	13x25	75	40	4	40	80	-	420	362	320	-	820
DTM.30040	M.12	13x25	90	45	6	50	110	-	-	590	532	483	1200

Product Code	T Adj. Arm Flat Thickness	EAL Adj. Arm Length	Profile Section	Surface Lock Nut	Ø	S
	mm	mm			Pin Size	Bolt Size
					DTM.30010	3
DTM.30020	3,5	50-90	21x41 - 41x41	PLGMK.6100	5	M10x25
DTM.30030	3,5	50-90	21x41 - 41x41	PLGMK.6100	5	M10x25
DTM.30040	4,5	60-120	45x45 - 45x60	PLGMK.8200	5	M12x30

- Material: Stainless Steel 1.4301 (A2) & 1.4401 (A4).
- For more specific data is about section and surface lock nuts, please see PROLINK G and PROLINK C catalogue.
- For Adjustable Arm, please see the data sheet of 'LBE Adjustable Arm'.
- Bolts, Surface Lock Nut, Adjustable Arm are provided separately.

## Facade Fixings and Anchoring Systems / Z Anchor

### Z Anchor Technical Details

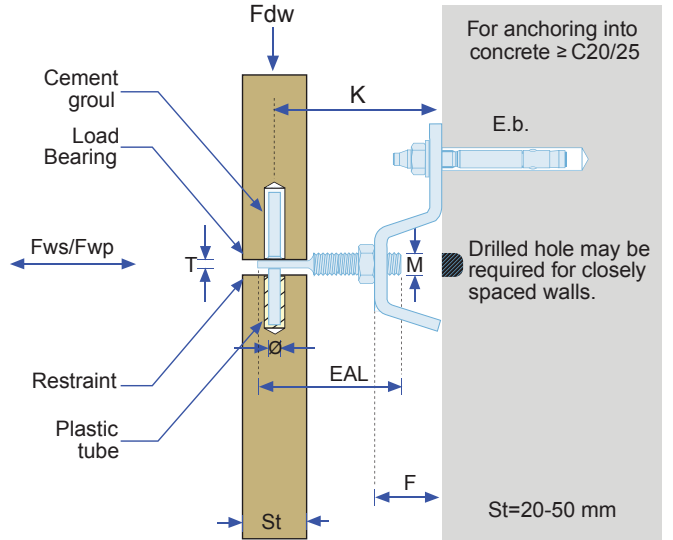
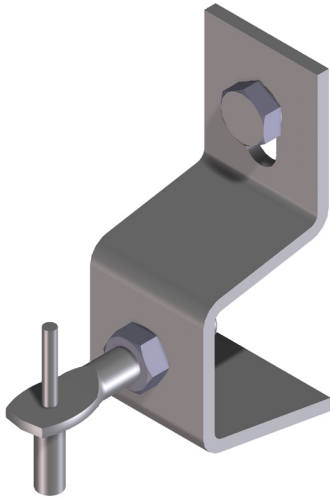

Product Code	Technical Details											
	Projection	Min. Projection	Max. Projection	Dead Load	Forming Size	Wind-Pressure	Wind-Suction	Expansion Bolt Size	Pin Size	Adj. Arm Metric Size	Adj. Arm Flat Thickness	Adj. Arm Length
	K (mm)	K - (mm)	K + (mm)	Fdw (N)	F (mm)	Fwp (N)	Fws (N)	E.b. (mm)	Ø (mm)	M (mm)	T (mm)	EAL (mm)
ZS.27.15.M10	40	35	55	200	15	312	219	M8X80	5	M10	3.5	60
ZS.27.35.M10	50	45	65		35							60
ZS.27.55.M10	70	55	85		55							70
ZS.27.75.M10	90	75	105		75							70
ZS.40.20.M10	55	50	70	300	20	468	328	M8X80	5	M10	3.5	60
ZS.40.40.M10	75	60	90		40							60
ZS.40.60.M10	95	80	105		60							60
ZS.40.80.M10	115	100	125		80							60
ZS.27.15.M12	50	40	65	400	15	624	437	M8X80	5	M12	4.5	70
ZS.27.35.M12	70	55	85		35							80
ZS.27.55.M12	90	75	105		55							80
ZS.27.75.M12	110	95	125		75							80
ZS.40.20.M12	75	60	90	500	20	780	546	M8X80	5	M12	4.5	80
ZS.40.40.M12	95	80	110		40							80
ZS.40.60.M12	115	100	130		60							80
ZS.40.80.M12	135	120	150		80							80

- Material: Stainless Steel 1.4301 (A2) & 1.4401 (A4).
- Table above is prepared according to DIN 18516 standards.
- Loads stated are working resistance loads.
- Other sizes are available for production upon request.
- Bolts are provided separately.
- Structural calculation reports are available upon order.

Facade Fixings and Anchoring Systems / Application Details

Z Anchor Fixing System  
Application Details

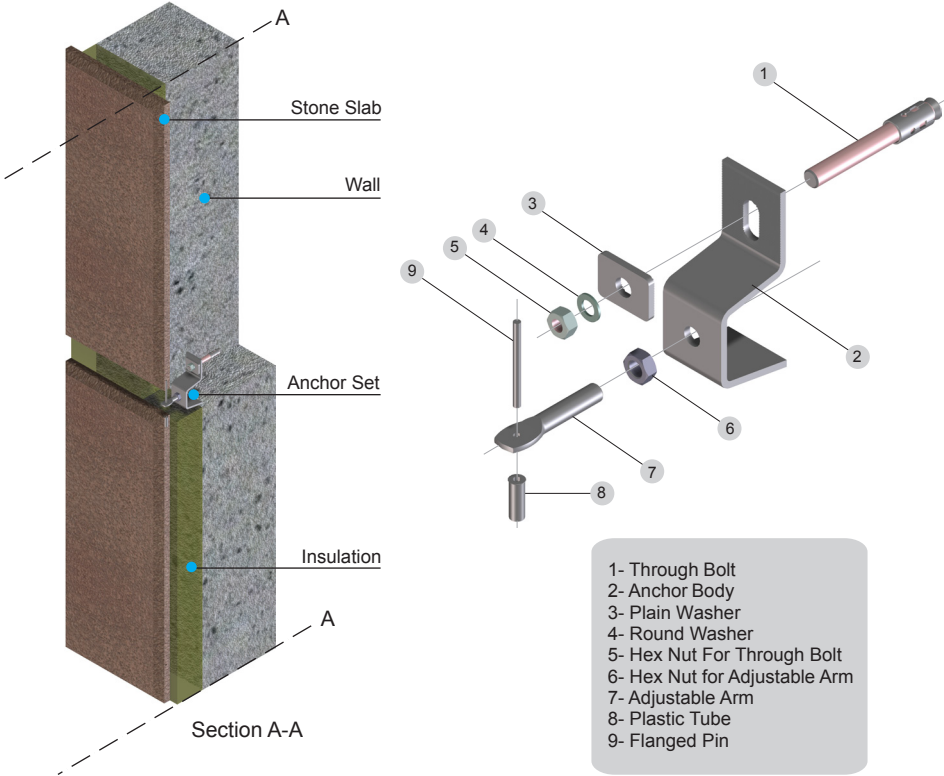

Installation at horizontal joints

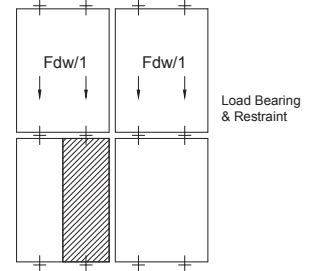

In this instance the dead load of the slab is divided by two, as half the weight of the slab is transferred to the load bearing anchors.

Installation at vertical joints

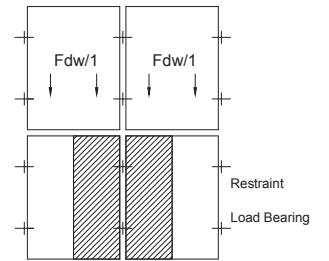

In this instance the dead load of the slab is divided by one, as the whole weight of the slab is transferred to the load bearing anchors.

Installation at horizontal joints

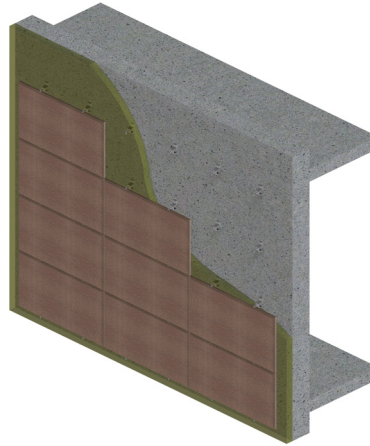
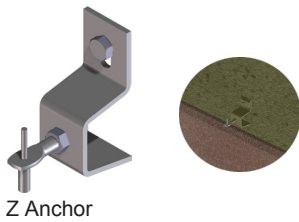

Installation at vertical joints

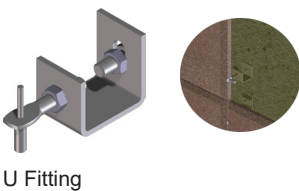
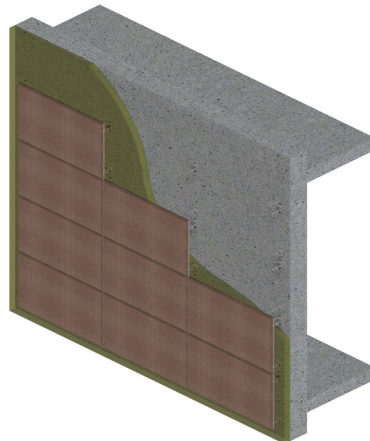
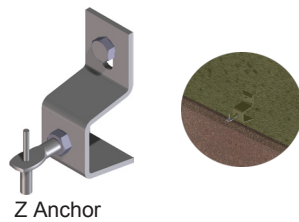

Elevation view

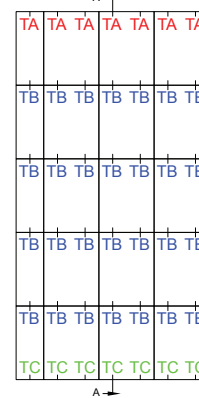

Installation Details

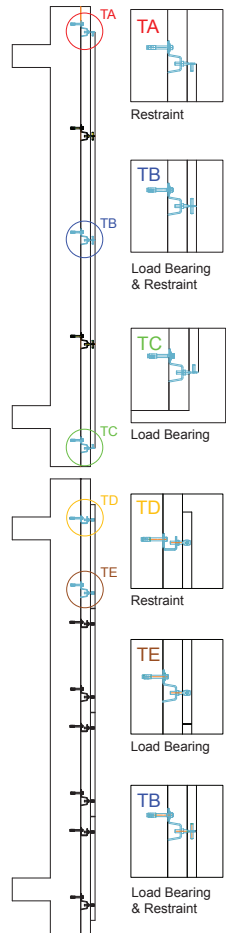

Elevation view

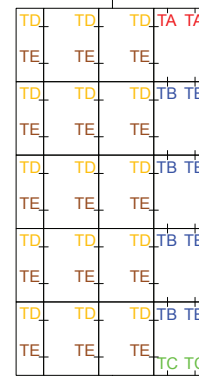

## Z Anchor Fixing System Technical Details

### Technical Details

- Direct fixing into concrete walls with expansion bolts. Indirect fixing into sub channel system with hex bolts
- Three dimensional adjustability - Quick and easy fixing
- Recommended projection sizes up to 135 mm & loads up to 800 N.

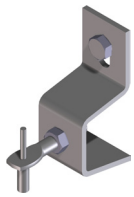

Z Anchor

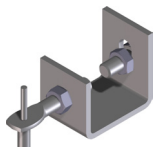

U Fitting

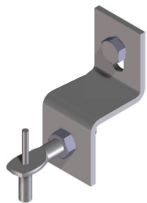

Z Anchor.v1



Soffit Anchor

### Three Dimensional adjustability

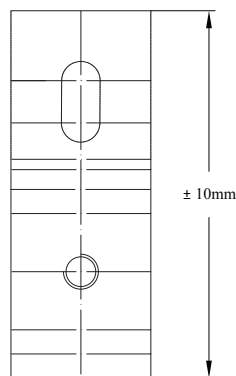

1) Vertical adjustment is provided by the slotted hole. The anchor is fixed on to the bolt with the serrated washer at the desired level.

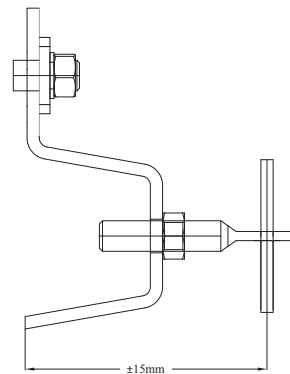

2) Adjustment of the projection size is provided by rotating the adjustable body. The adjustable arm is locked with the hexagon nut.

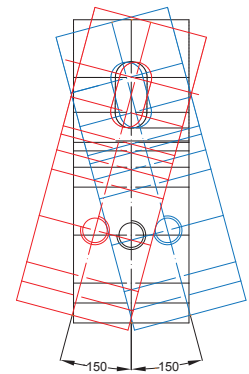

3) Adjustment of the anchor left and right is provided by sliding the body up to 15 degrees side ways.

### Installation vertical joints

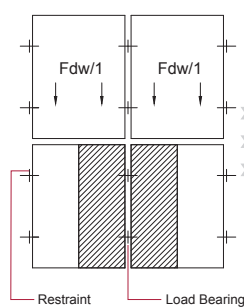

### Installation horizontal joints

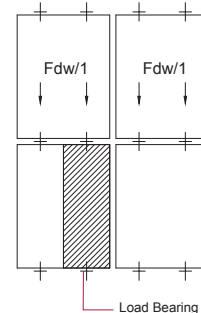

- Suitable for concrete walls. Anchors are fixed directly on to concrete walls with expansion bolts.
- Recommended projection size between 45 mm to 135 mm and loads up to 800 N.
- In horizontal joint installation, slabs are pinned on the bottom and upper sides. Anchors act as load bearing carrying half the weight of the slabs above. Anchors also act as restraints, holding the slabs below and restraining against wind suction and pressure.
- In vertical joint installation slabs are pinned on the left and right sides. Anchors on the bottom are load-bearing anchors carrying the whole weight of the slab. Half the weight of the slab on the left and half the weight of the slab on the right. Anchors on the top are restraint anchors holding the slabs and restraining against wind suction and pressure.
- Three - dimensional adjustability allows quick and easy installation.
- The design and structural calculations of these anchors are made in our technical department. Special design and manufacturing can be made for the requirements of each project.

Facade Fixings and Anchoring Systems / Adjustable Arm

LBE  
Technical Details

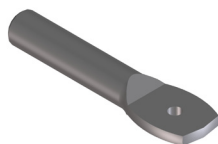

LBE Adjustable Arm

Product Code	Technical Detail					Stone Thickness	Distance between Edge & Hole
	Metric Size	Length	Flat length Size	Flattening Thickness	Pin Diameter		
	M (mm)	L (mm)	AF (mm)	T (mm)	Ø (mm)	St (mm)	A (mm)
LBE 51001	8	50	A+6	3	4	20	12-13
LBE 51002	8	60	A+6	3	4	25	14-16
LBE 51003	8	70	A+6	3	4	30	16-17
LBE 51010	10	50	A+8	3.5	5	40	22-24
LBE 51011	10	60	A+8	3.5	5	50	26-29
LBE 51012	10	70	A+8	3.5	5		
LBE 51013	10	80	A+8	3.5	5		
LBE 51030	12	50	A+8	4.5	5		
LBE 51031	12	60	A+8	4.5	5		
LBE 51032	12	70	A+8	4.5	5		
LBE 51033	12	80	A+8	4.5	5		
LBE 51040	14	50	A+8	5.5	6		
LBE 51041	14	60	A+8	5.5	6		
LBE 51042	14	70	A+8	5.5	6		
LBE 51043	14	80	A+8	5.5	6		
LBE 51050	16	50	A+8	6	6		
LBE 51051	16	60	A+8	6	6		
LBE 51052	16	70	A+8	6	6		
LBE 51053	16	70	A+8	6	6		

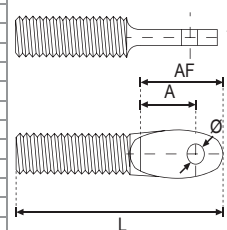

Type 2 With welded pin

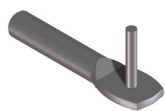

Type 3 With welded plate

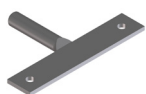

Type 4 With welded plate&pins



LBE-FP

Flanged Pin



Product Code	Technical Details		
	Diameter	Length	Flange Diameter
	Ø (mm)	L (mm)	FØ (mm)
LBE-FP 61001	4	50	5
LBE-FP 61010	5	60	6
LBE-FP 61020	5	70	6
LBE-FP 61030	6	70	7

PLGMK-PW

Plain Washer



Product Code	Technical Details			
	Thick-ness	Height	Width	Length
	T (mm)	H (mm)	W (mm)	L (mm)
PLGMK-PW 4000	2.5	22	30	Ø7
PLGMK-PW 4001	2.5	22	30	Ø9
PLGMK-PW 4002	3	26	34	Ø11
PLGMK-PW 4003	3	26	34	Ø13

LBE-SP

Straight Pin



Product Code	Technical Details	
	Diameter	Length
	Ø (mm)	L (mm)
LBE-SP 71001	4	60
LBE-SP 71010	5	60
LBE-SP 71020	5	70
LBE-SP 71030	6	70

PLGMK-LN

Lock Nut

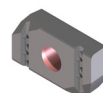

Product Code	Technical Details			
	Thick-ness	Height	Width	Metric Hole
	T (mm)	H (mm)	W (mm)	M (mm)
PLGMK-LN 2900	6	20	34	M6
PLGMK-LN 3000	8	20	34	M8
PLGMK-LN 3100	9	20	34	M10
PLGMK-LN 3200	10	20	34	M12

LBE-PT

Plastic Tube



Product Code	Technical Details		
	Inner Diameter	Outer Diameter	Length
	In. Ø (mm)	Ou. Ø (mm)	L (mm)
LBE-PT 91030	4.5	6	30
LBE-PT 91040	5.5	7	40
LBE-PT 91050	6.5	8	40



### Natural Stone Fixing System

- High load capacity and adjustable profile system
- Quick and easy fixing
- Projection sizes between 90mm - 260mm



PLGD 4141 Profile

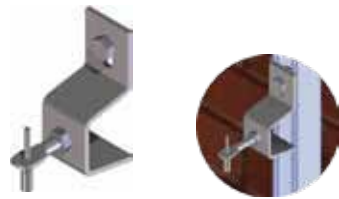

Z Anchor



Double L Adjustable Fitting

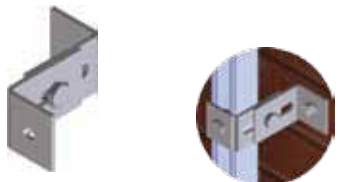

Double L Adjustable Fitting.v1

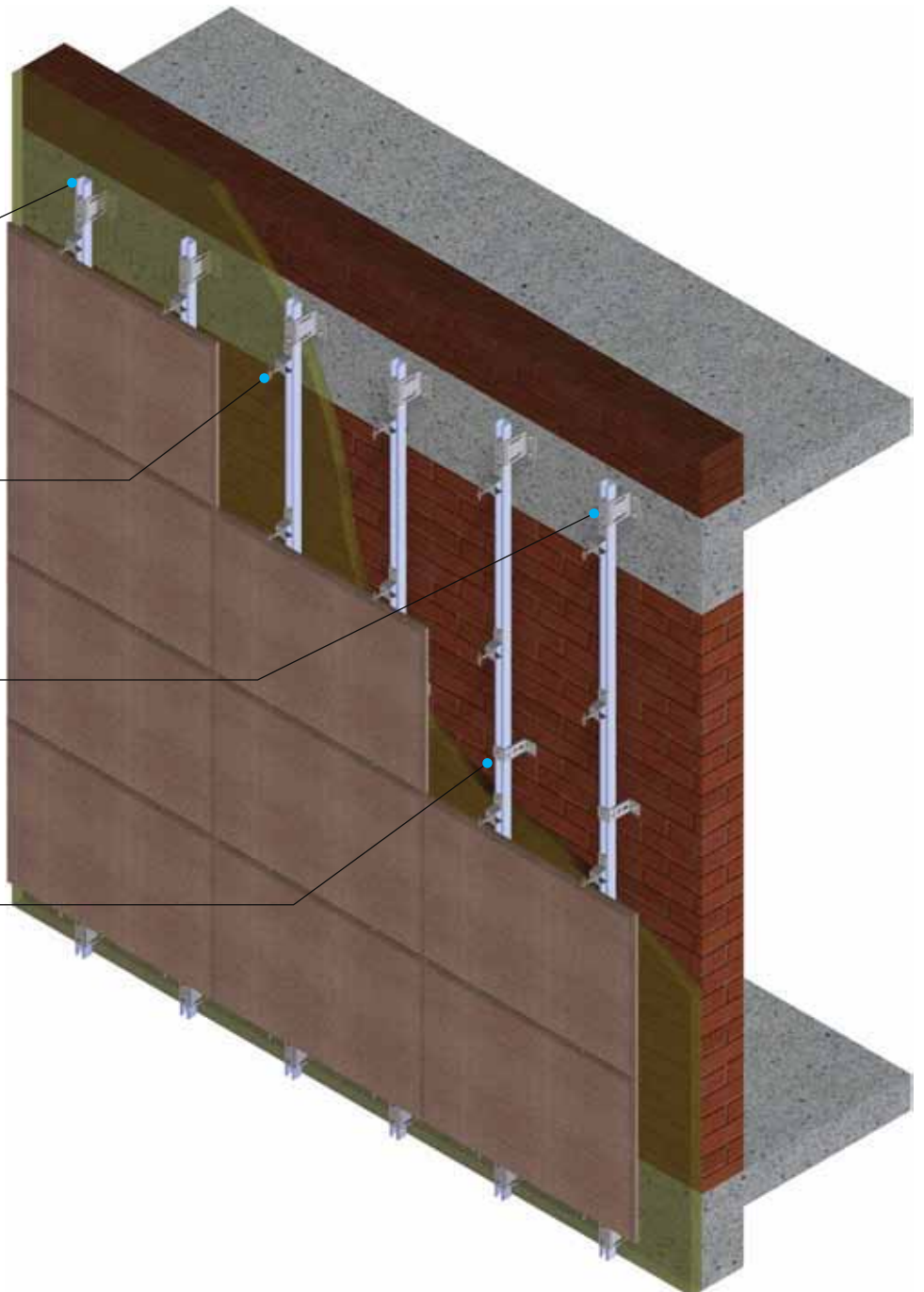

### Natural Stone Fixing System

- High load capacity and adjustable profile system
- Quick and easy fixing
- Projection sizes between 90mm - 260mm



PLGD 4141 Profile



Z Anchor



Double L Adjustable Fitting



Double L Adjustable Fitting.v1



LSD 9020

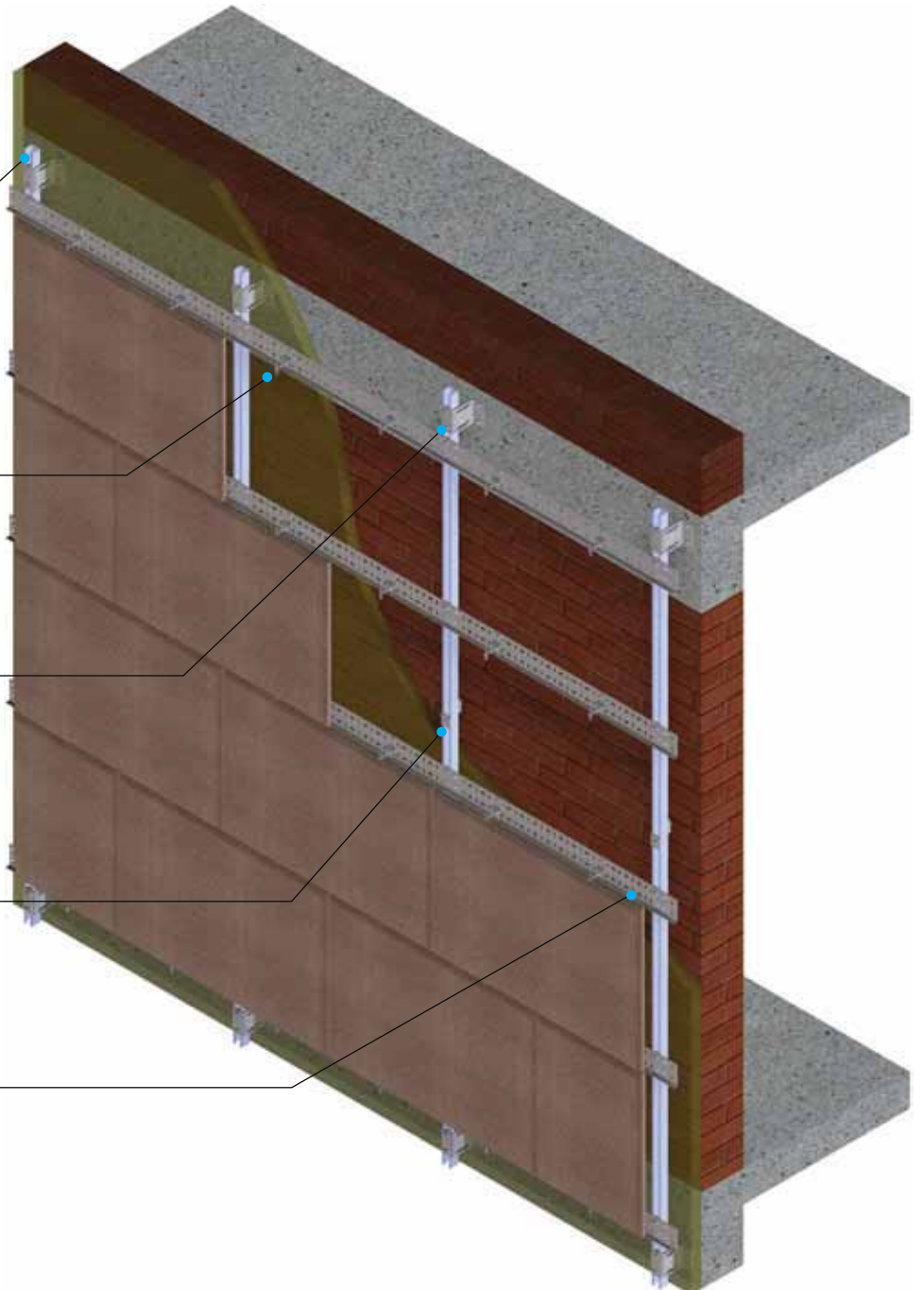

### Natural Stone Fixing System

- High load capacity and adjustable profile system
- Quick and easy fixing
- Projection sizes between 90mm - 260mm

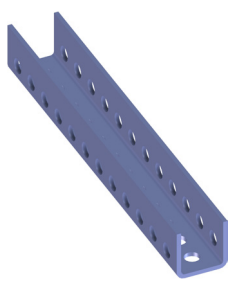

UYD 3535-U Profile

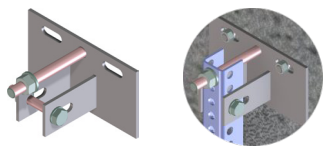

Base Plate

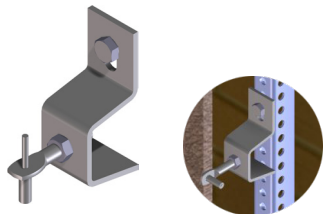

Z Anchor

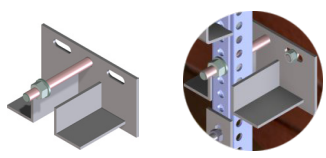

Base Plate.v1

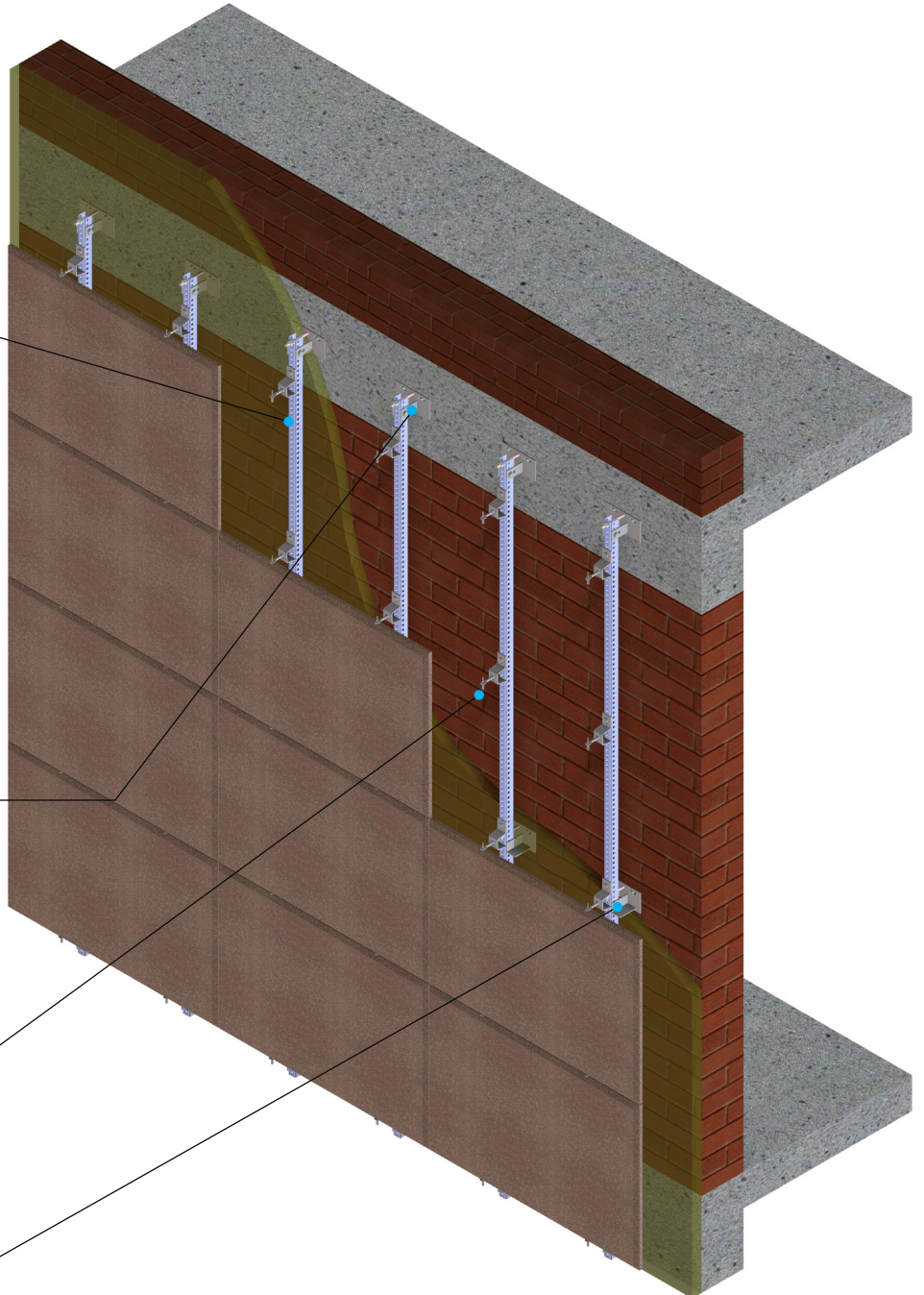

### Natural Stone Fixing System

- High load capacity and adjustable profile system
- Quick and easy fixing
- Projection sizes between 110mm - 200mm

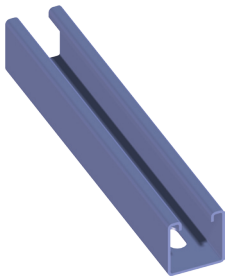

PLG 4141-G Profile

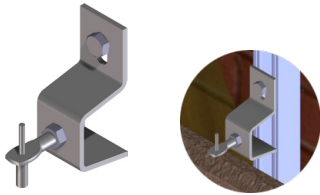

Z Anchor

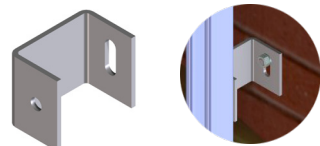

U Fitting

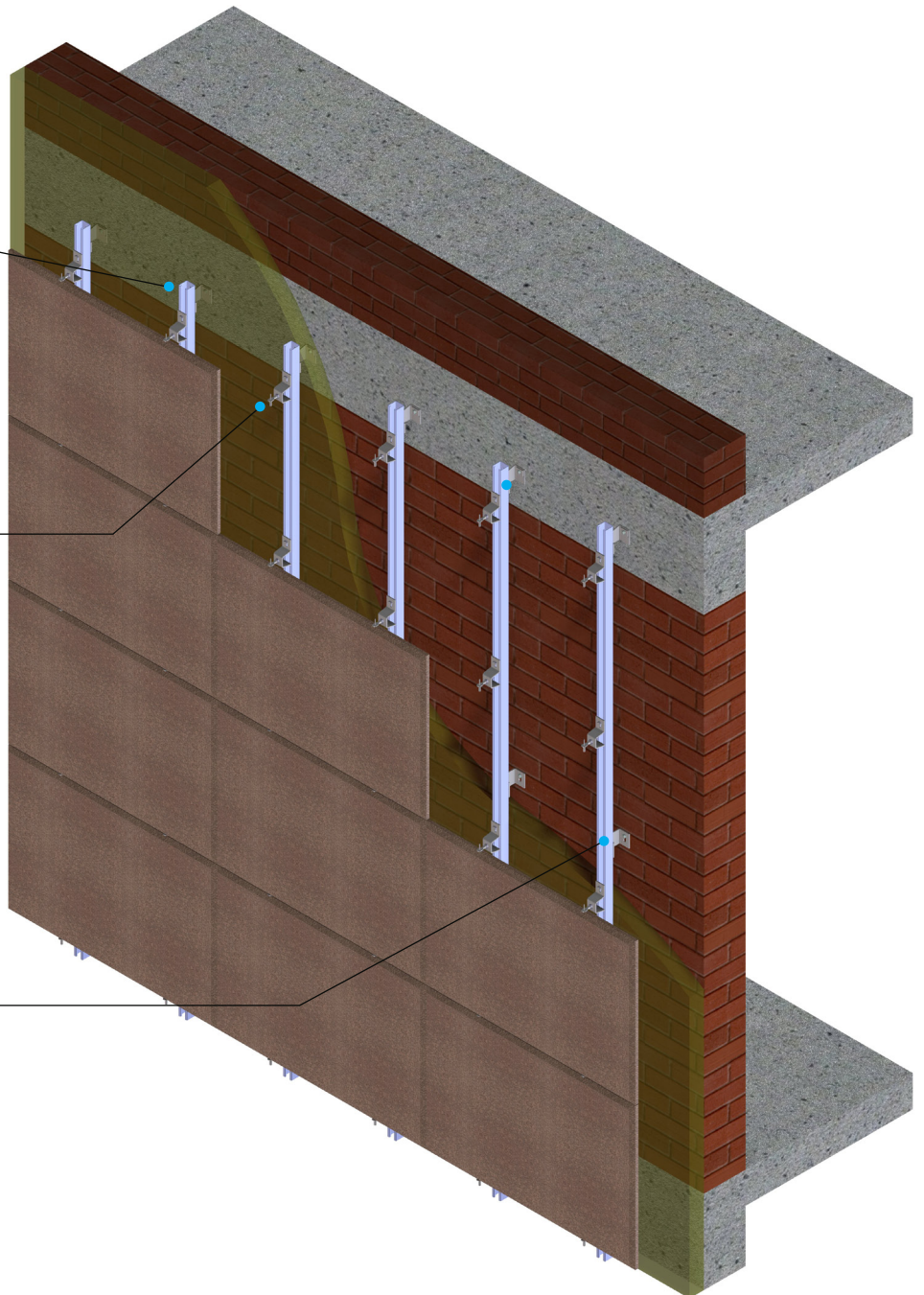

### Natural Stone Fixing System

- Profile system in both horizontal and vertical axis
- Quick and easy adjustability in horizontal axis
- Projection sizes between 150mm - 240mm
- Suitable for non-parallel stone arrangement



PLG 2141 Profile

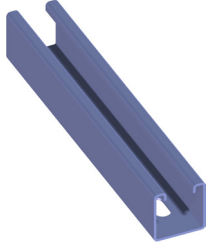

PLG 4141 Profile



PLGUBF 6433 - U Fitting

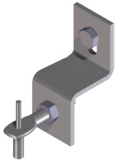
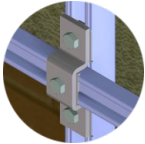

Z Anchor.v1

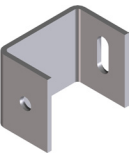

U Fitting

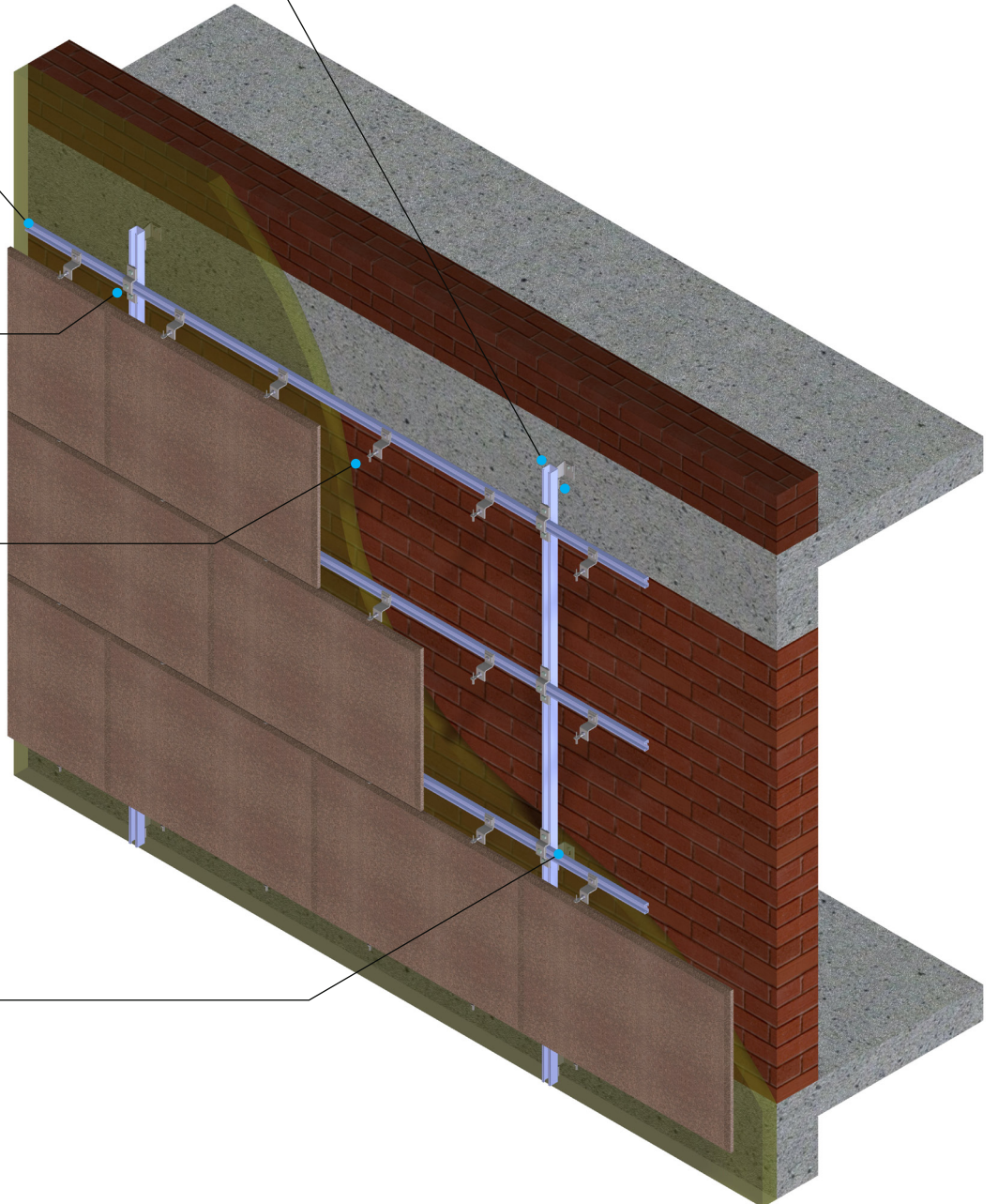
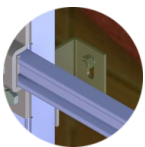

LINK YAPI SAN. VE TİC. A.Ş.

HEADQUARTER : GEBZE OSB2 MAH. 1000. CAD. NO:1016/1 ÇAYIROVA/KOCAELİ TEL: +90 444 54 65 FAX: +90 262 751 33 23

[www.linkyapi.com](http://www.linkyapi.com)